

SILVERCUT®

PRODUCTION AND SPECIAL
PURPOSE CUTTING MACHINES
SINCE 1924



Inclined loader for the RS 350N Servo series

to automate the machine feeder unit.

SilverCut has upgraded the wet and dry cut-off machines of the RS 350 series – in particular the RS 350N Servo system – with an inclined loader and an automatic feeder unit including segregation.



For round steel
rods 5 to 25 mm
in diameter

Your advantages:

- + **Inclined loader**
for round steel rods
4000 mm in length
- + Also supply via
integrated linear feeder unit
[gripper feed]
- + **Control** and monitoring
of the inclined loader and
feeding system **integrated**
into the machine's controller
- + Protection against intervention
in the danger zone: control side
with **light grid**, back side with
safety railing

SILVERCUT®

**PRODUCTION AND SPECIAL
PURPOSE CUTTING MACHINES**
SINCE 1924

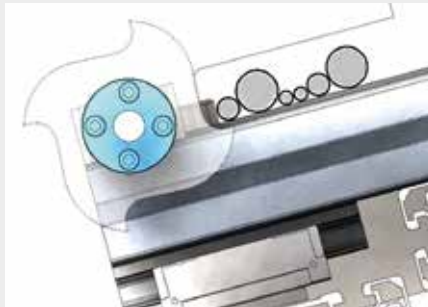
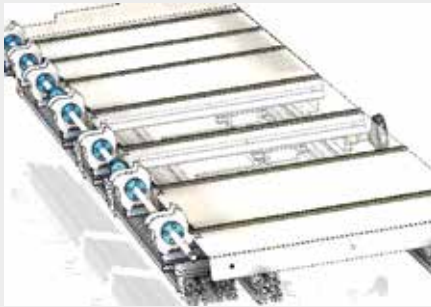

Inclined loader:

- Width approx. 400 mm
- With stopper, segregation, transfer to feed and cover star
- Tool size can be set using central handwheel
- Manual loading

Feed:

- With integrated feeder unit (servo linear axle 100 mm)
- With stainless steel tray for coolant return

EVERYTHING FROM A SINGLE SOURCE

Thanks to our integration into the **PÜTZ GROUP** and the resulting **synergy effects** we are able to offer you not just production and specialist cutting machines but also the appropriate testing technology to test surfaces as well as dimensional accuracy.

Cutting starts where sawing ends.

SilverCut GmbH
Bahnhofstraße 8/1
74821 Mosbach
GERMANY

Phone +49 6261 9726-0
Fax +49 6261 9726-10
info@silvercut.de
www.silvercut.de

Good reasons for SILVERCUT ...

More than 40 years of experience in cutting technology and more than 2,800 delivered cutting systems speak for themselves.

**We look forward
to hearing from you!**